



SATURN P LED E



SATURN P LED HPE



IP65

SATURN P LED

RG0



m²
0,19

220-240V
50-60Hz



CORPO: Corpo in lega d'alluminio pressofuso con interni in ferro zincato a caldo bianco verniciato con polveri poliesteri, colore standard nero grafite. Trattamento chimico di sgrassaggio e fosfatazione del grezzo, resistente a raggi UV e nebbie saline.

GUARNIZIONI: in silicone

UNITÀ DI ALIMENTAZIONE: Apertura del vano elettrico dall'alto con viti inox AISI 304. Sezionatore automatico di linea. Componenti elettrici montati su piastra di fissaggio facilmente rimuovibile. Alimentatore elettronico full dim per applicazioni outdoor. Efficienza a pieno carico > 90%, durata di vita 100000h a Tc life. 220÷240V / 50-60Hz. Classe di isolamento II. Fattore di potenza >0,98.

CONNESSIONE: pressacavo M20 (cavo 9÷11mm).

MODULI LED: moduli LED costituiti da 12/24 chip multi/die ad alta potenza di ultima generazione. Elevata precisione delle caratteristiche cromatiche conformi ai bin ANSI a 85°C. Efficienza 170lm/W @ 640mA 25°C. Vita utile del led 80.000h L80B20. Concetto di illuminazione Multi-layer in cui ogni ottica illumina tutta l'area in modo da garantire i parametri di uniformità anche in caso di spegnimento di qualche LED.

ATTACCO PALO: Montaggio a sbraccio o testapalo diametro 60mm, inclinazione variabile con step di 2,5°.

BODY: Body made of die-cast aluminium with inside part of white galvanized iron, polyester powder coated in standard graphite black colour. Degreasing chemical treatment and phosphatizing of the raw, UV and saline fog resistant.

GASKET: made in silicone

POWER UNITS: Top opening with stainless steel screws INOX AISI 304. Automatic power cut - off device. Electrical components mounted on easily removable fixing plate. Full load efficiency >90%. Power supply expected life at Tc life 100.000h. 220÷240V / 50-60Hz. Insulation Class II. Power factor >0,98.

CONNECTION: M20 cable gland (9÷11mm cable)
LED MODULES: LED modules consisting of 12/24 new generation multi/die, high power package chips.

Hot/color targeting ensures color is with ANSI bin at 85°C. Efficiency 170lm/W @ 640mA 25°C). Useful life of the led 80.000h L80B20. Secondary optic made of stabilized PMMA. Multi-layer lighting concept in which each optic illuminates the entire surface to ensure uniformity even when some LEDs are failed.

POLE CONNECTION: Post top or side mounting diameter 60mm, adjustable tilt by 2,5° steps.

DIMENSIONI - DIMENSIONS

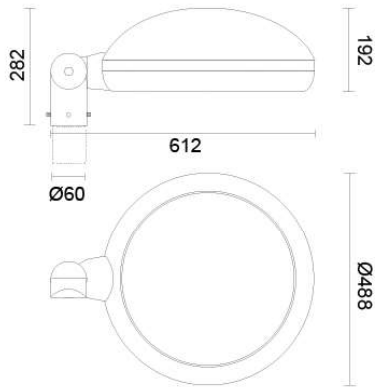

SATURN P LED E

SCHERMO: Vetro di chiusura piano temperato spessore 4 mm.

SCREEN: Closing flat tempered glass, thickness 4mm.

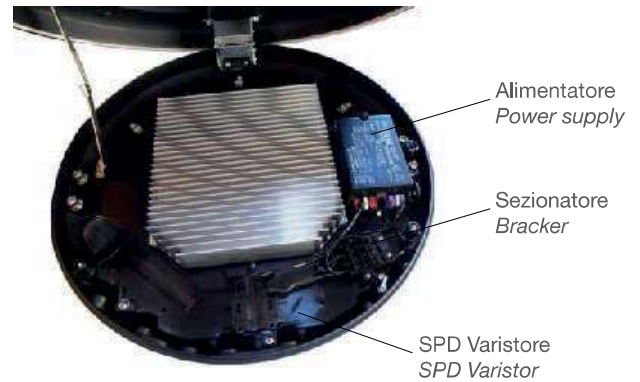
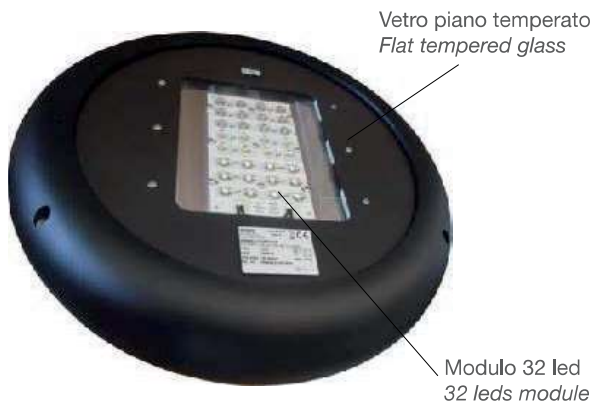

SATURN P LED HPE

SCHERMO: Modulo lenti in PMMA stabilizzato con guarnizione al silicone che garantiscono il grado di protezione IP65 e la massima efficienza lm/W.

SCREEN: Optical group consisting of a lens module in stabilized PMMA that also guarantees sealing and maximum efficiency lm/W.

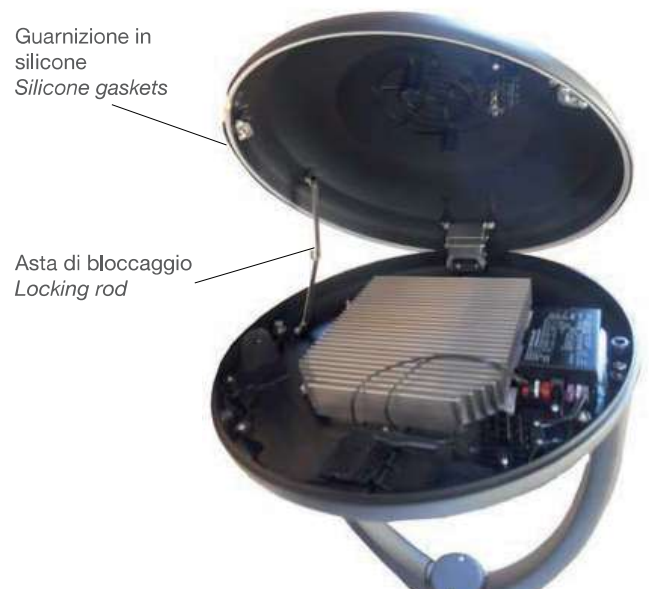

SATURN P LED E

▲ DATI IDENTIFICATIVI E PRESTAZIONI - IDENTIFICATION DATA AND PERFORMANCES

| Codice iniziale Initial code | Nome Name | Watt | mA max | N. Led | Lm out | Kelvin | CRI | IP | CL | Col | Weight |
|---------------------------------|-------------------------|------|-----------|--------|-----------|--------|-----|----|----|------------|--------|
| 000681233_P | SATURN P E 12LED 39W 3K | 39 | 500 | 12 | 4700 | 3000 | 70 | 65 | II | RAL 9011 ■ | 10,5 |
| 000681234_P | SATURN P E 12LED 39W 4K | 39 | 500 | 12 | 5050 | 4000 | 70 | 65 | II | RAL 9011 ■ | 10,5 |
| 000682433_P | SATURN P E 24LED 70W 3K | 70 | 450 | 24 | 8550 | 3000 | 70 | 65 | II | RAL 9011 ■ | 11,5 |
| 000682434_P | SATURN P E 24LED 70W 4K | 70 | 450 | 24 | 9550 | 4000 | 70 | 65 | II | RAL 9011 ■ | 11,5 |

Come comporre il codice prodotto (rispettare la sequenza): **Codice iniziale (▲) Codice finale (●) Dimmerazione (■)**
 How to compose the product code (respect the sequence): **Initial code (▲) Last number (●) Dimming profile (■)**

PERFORMANCE - PERFORMANCES

| N. LED | mA | Watt | 3000K LED Lumen | 3000K Lm output | 4000K LED Lumen | 4000K Lm output |
|--------|-----|------|--------------------|--------------------|--------------------|--------------------|
| 12 | 200 | 16 | 2650 | 2250 | 2850 | 2400 |
| | 350 | 27 | 4200 | 3350 | 4550 | 3850 |
| | 500 | 39 | 5550 | 4700 | 6000 | 5050 |
| 24 | 200 | 32 | 5300 | 4450 | 5750 | 4850 |
| | 350 | 53 | 8450 | 7100 | 9100 | 7650 |
| | 450 | 70 | 10550 | 8850 | 11350 | 9550 |

● FOTOMETRIE - PHOTOMETRY

| Codice finale Last number | Ottica Optics |
|------------------------------|------------------|
| 2 | S1 |
| 3 | S3 |
| 9 | SQ |

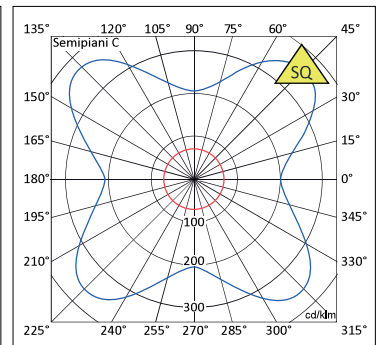
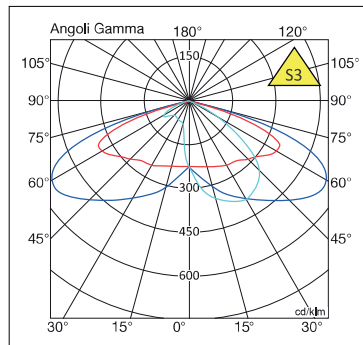
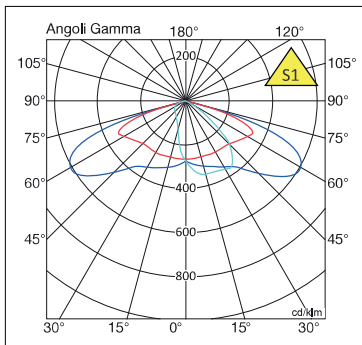

■ DIMMERAZIONE - DIMMING

| Code | Rset | Switch | 1-10V | Dali | CLO | Crono timer | Mains dim | Conveyed waves |
|------|------|--------|-------|------|-----|-------------|-----------|----------------|
| - | S* | / | / | S* | / | S* | S* | / |

- S Standard con possibilità di programmazione dopo l'acquisto.
 - S* Standard con programmazione da eseguire in azienda.
 (vedi modulo dimmer disponibile sul sito Web www.faeber.com)

- S Standard with possibility of setting after purchase
 - S* Standard with setting to be done at the factory
 (see dimming form available on website www.faeber.com)

OTTICA - OPTICS

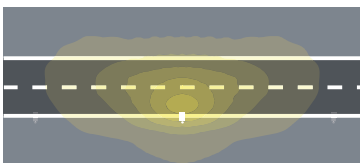

S1 - Per strade standard
 S1 - For standard streets

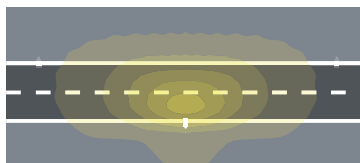

S3 - Per strade larghe
 S3 - For wide streets

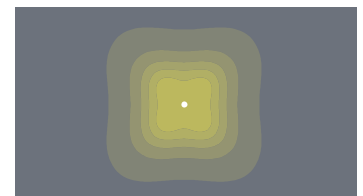

SQ - Per piazze e parchi
 SQ - For squares and parks

ACCESSORI - ACCESSORIES: rif pagg. 84-85

SATURN P LED HPE

▲ DATI IDENTIFICATIVI E PRESTAZIONI - IDENTIFICATION DATA AND PERFORMANCES

| Codice iniziale Initial code | Nome Name | Watt | mA max | N. Led | Lm out | Kelvin | CRI | IP | CL | Col | Weight |
|---------------------------------|---------------------------|------|-----------|--------|-----------|--------|-----|----|----|------------|--------|
| 000571233_P | SATURN P HPE 12LED 39W 3K | 39 | 500 | 12 | 5250 | 3000 | 70 | 65 | II | RAL 9011 ■ | 10,5 |
| 000571234_P | SATURN P HPE 12LED 39W 4K | 39 | 500 | 12 | 5650 | 4000 | 70 | 65 | II | RAL 9011 ■ | 10,5 |
| 000572433_P | SATURN P HPE 24LED 78W 3K | 78 | 500 | 24 | 10450 | 3000 | 70 | 65 | II | RAL 9011 ■ | 11,5 |
| 000572434_P | SATURN P HPE 24LED 78W 4K | 78 | 500 | 24 | 11300 | 4000 | 70 | 65 | II | RAL 9011 ■ | 11,5 |

Come comporre il codice prodotto (rispettare la sequenza): **Codice iniziale (▲) Codice finale (●) Dimmerazione (■)**
 How to compose the product code (respect the sequence): **Initial code (▲) Last number (●) Dimming profile (■)**

PERFORMANCE - PERFORMANCES

| N. LED | mA | Watt | 3000K LED Lumen | 3000K Lm output | 4000K LED Lumen | 4000K Lm output |
|--------|-----|------|--------------------|--------------------|--------------------|--------------------|
| 12 | 200 | 16 | 2650 | 2500 | 2850 | 2700 |
| | 350 | 27 | 4200 | 3950 | 4550 | 4300 |
| | 500 | 39 | 5550 | 5250 | 6000 | 5650 |
| 24 | 200 | 32 | 5300 | 5000 | 5750 | 5400 |
| | 350 | 53 | 8450 | 7950 | 9100 | 8550 |
| | 500 | 78 | 11150 | 10450 | 12050 | 11300 |

● FOTOMETRIE - PHOTOMETRY

| Codice finale Last number | Optica Optics |
|------------------------------|------------------|
| 2 | S1 |
| 3 | S3 |
| 9 | SQ |

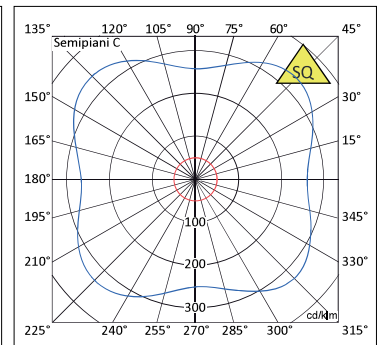
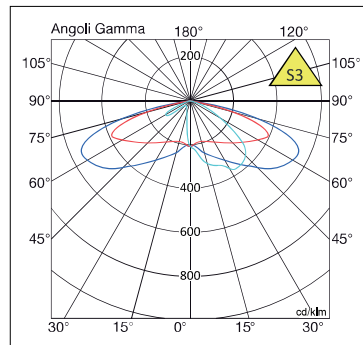
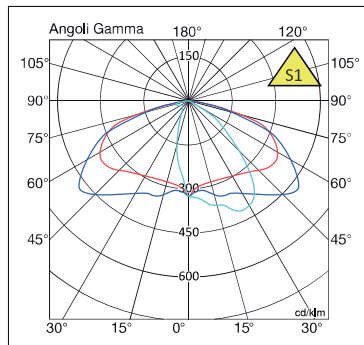

■ DIMMERAZIONE - DIMMING

| Code | Rset | Switch | 1-10V | Dali | CLO | Crono timer | Mains dim | Conveyed waves |
|------|------|--------|-------|------|-----|-------------|-----------|----------------|
| - | S* | / | / | S* | / | S* | S* | / |

- S Standard con possibilità di programmazione dopo l'acquisto.
 - S * Standard con programmazione da eseguire in azienda.
 (vedi modulo dimmer disponibile sul sito Web www.faeber.com)

- S Standard with possibility of setting after purchase
 - S* Standard with setting to be done at the factory
 (see dimming form available on website www.faeber.com)

OTTICA - OPTICS

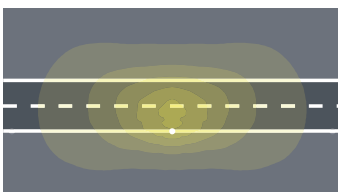

S1 - Per strade standard
 S1 - For standard streets

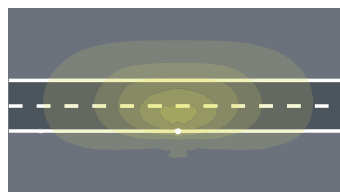

S3 - Per strade larghe
 S3 - For wide streets



SQ - Per piazze e parchi
 SQ - For squares and parks

ACCESSORI - ACCESSORIES: rif pagg. 84-85